

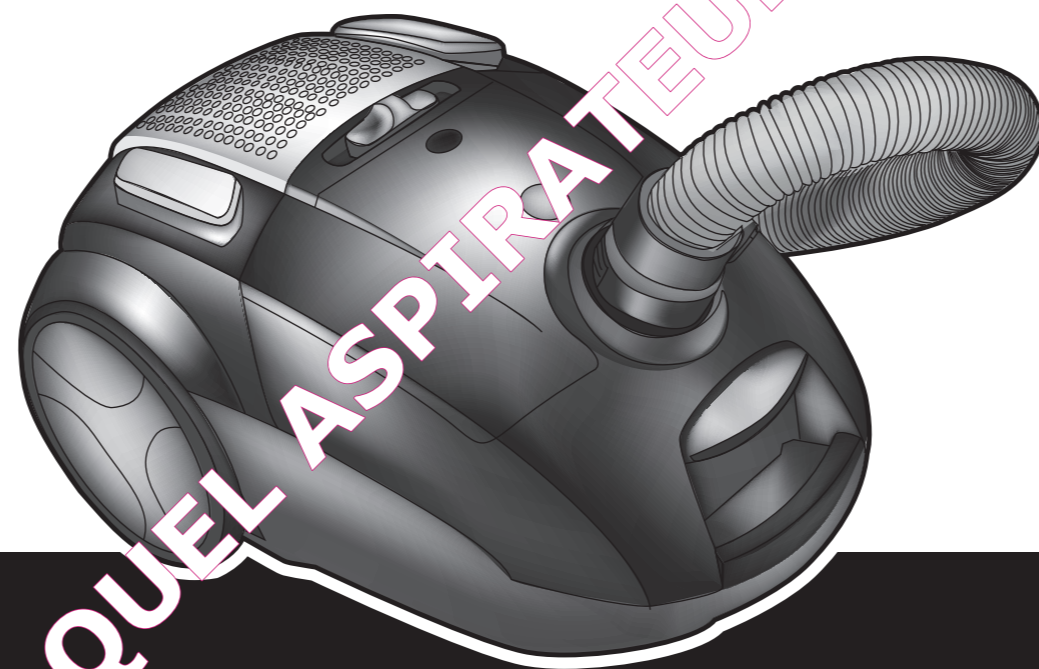

HOOVER



QUEL ASPIRATEUR.COM

USER MANUAL (GB)P 01
 MANUEL D'UTILISATION (FR)P 05
 BEDIENUNGSANLEITUNG (DE)P 09
 MANUALE ISTRUZIONI (IT)P 13
 GEBRUIKERSHANDLEIDING (NL)P 17
 MANUAL DE INSTRUÇÕES (PT)P 21
 MANUAL DE INSTRUCCIONES (ES)P 25
 BRUGERVEJLEDNING (DK)P 29
 BRUKSANVISNING (NO)P 33
 INSTRUKTIONSMANUAL (SE)P 36
 KÄYTTÖOHJE (FI)P 40
 (GR)P 44
 (RU)P 48
 I R T B I A R T H O (O 4
 NÁVOD K OBSLUZE (CZ)P 56
 NAVODILA ZA UPORABO (SI)P 60
 KULLANIM KILAVUZU (TR)P 64
 HASZNÁLATI ÚTMUTATÓ (HU)P 68

PRINTED IN P.R.C.
48011174/01

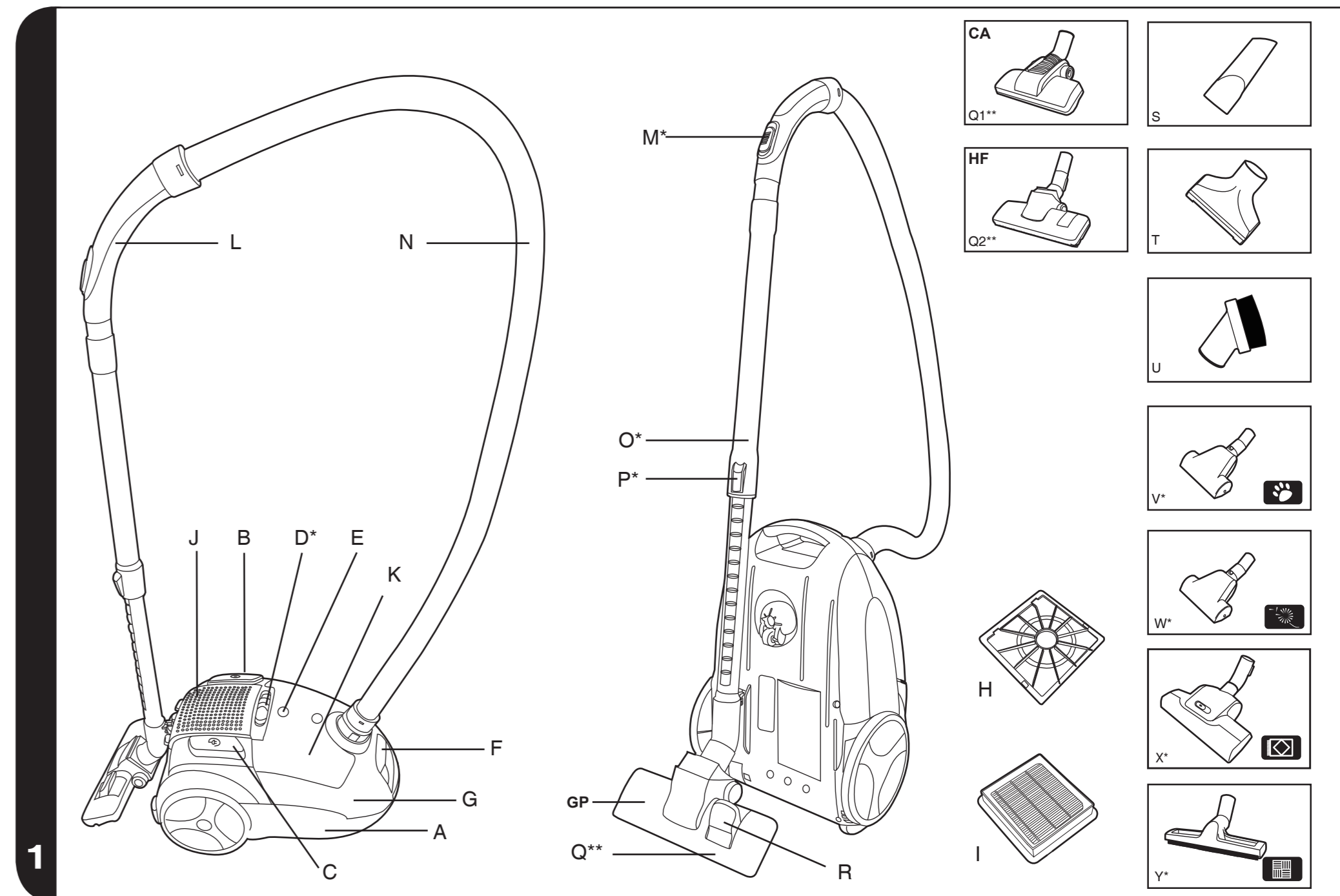

* Certain models only ** Certain models only, nozzles may vary according to model

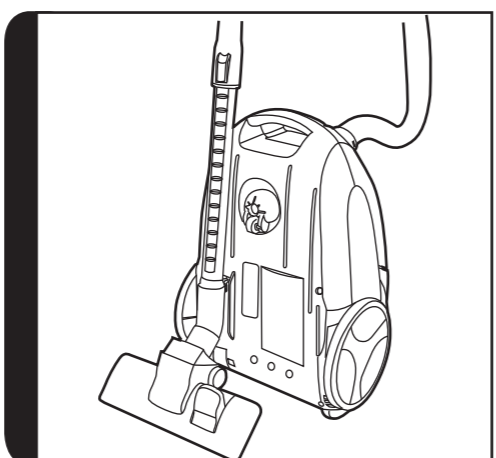
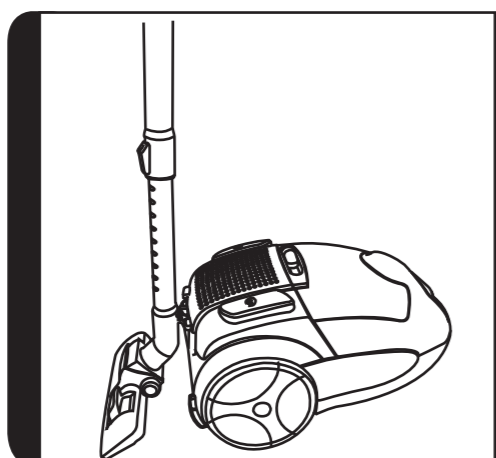
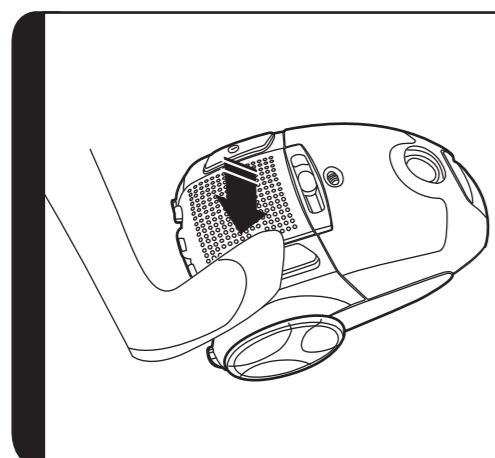
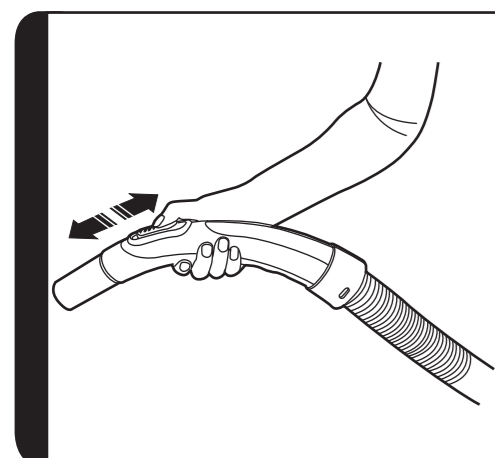
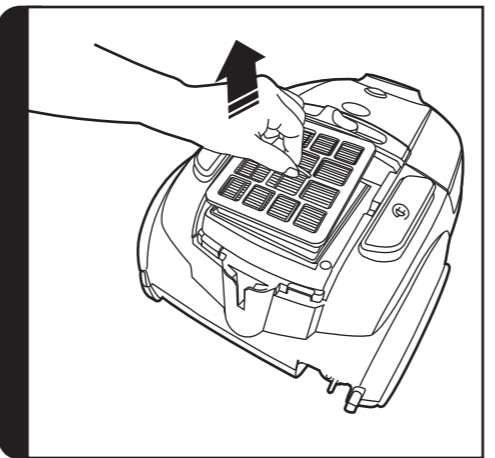
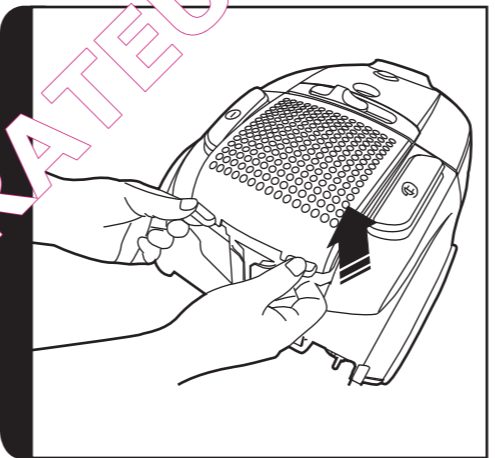
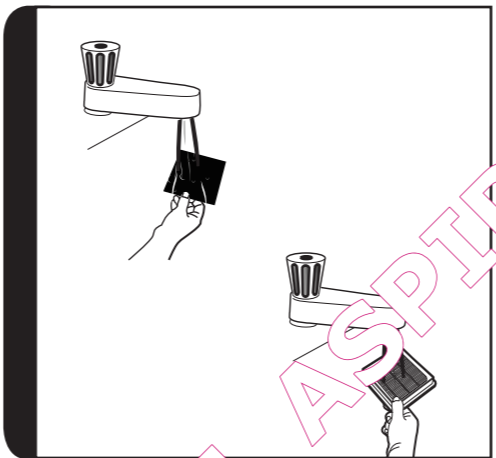
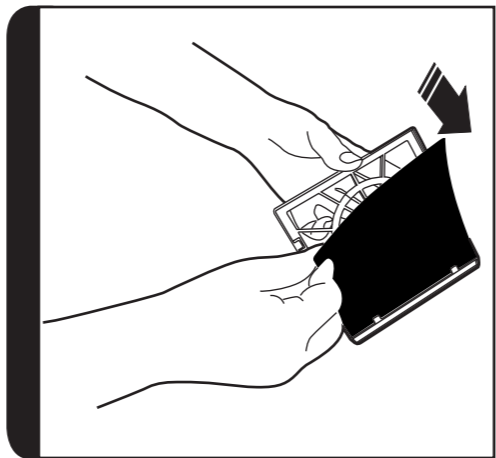
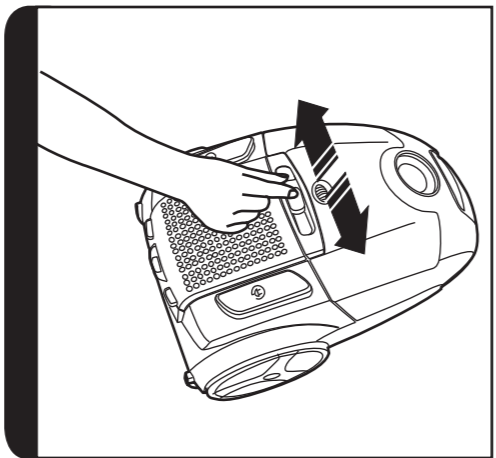
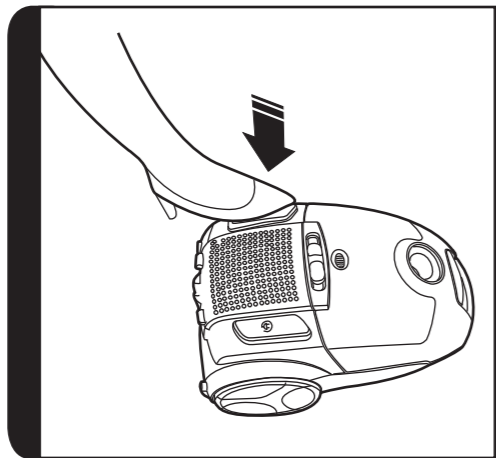
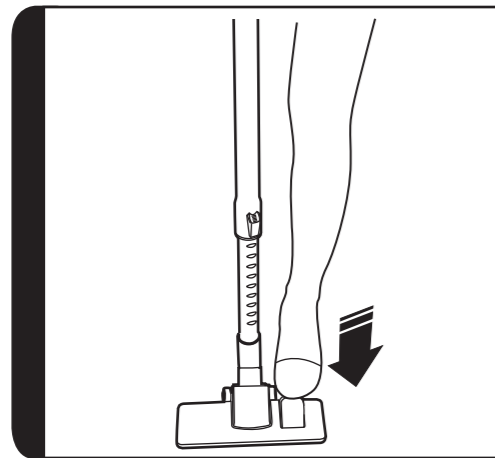
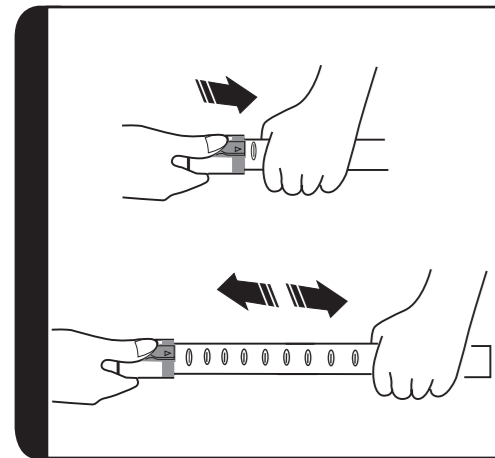
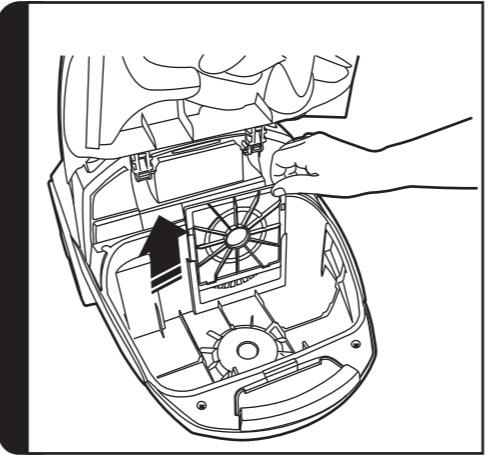
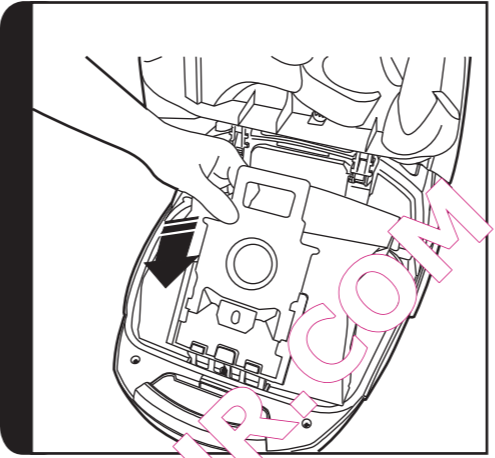
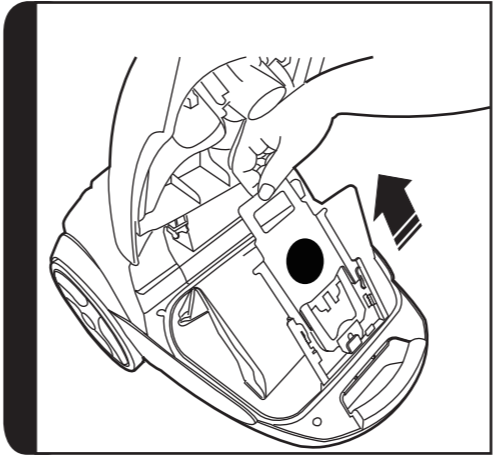
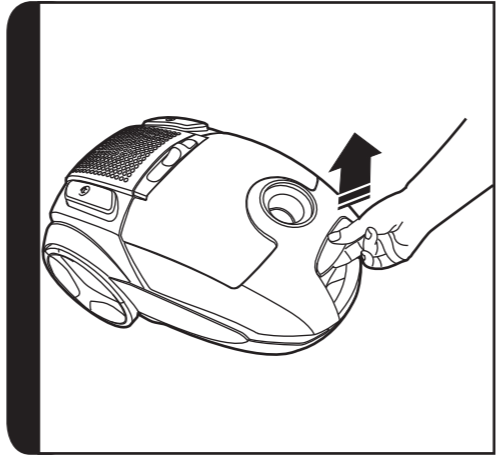
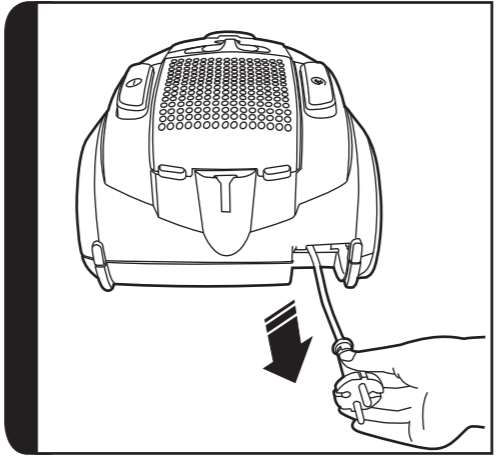
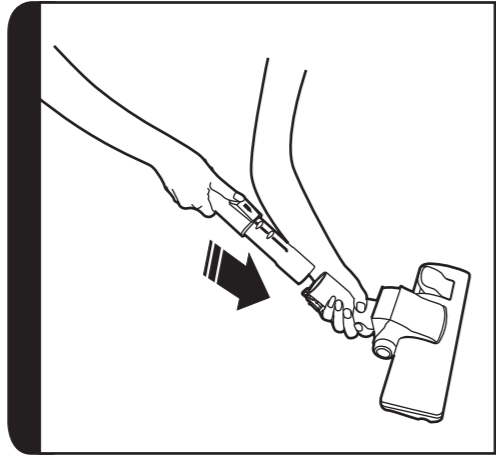
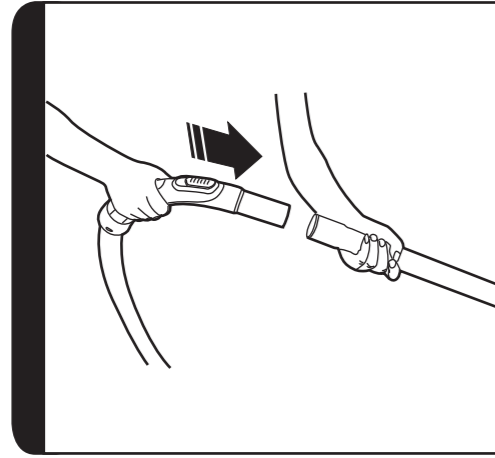
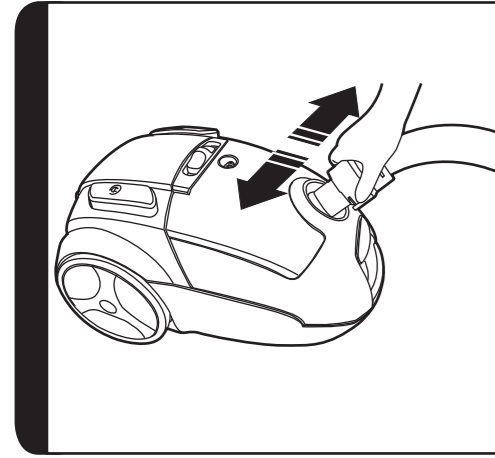

QUEL ASPIRATEUR.COM

* Certain models only

** Certain models only, nozzles may vary according to model

INSTRUCTIONS FOR SAFE USE

QUEL ASPIRATEUR.COM

HOOVER service:

H

C

C

H

The Environment



H

Static electricity:

A

F

CE

H

CF

C

C

GETTING TO KNOW YOUR CLEANER

- A. C
- . C
- C. C
- . C
- . C
- F. C
- . C
- H. F
- . F
- . F C
- . A
- . H H
- . H
- . A
- . C F GP
- . C CA
- . H F HF
- . F
- . C
- . F
- . H
- . A

ASSEMBLING YOUR CLEANER

- . C
- . C
- . C
- . [3]
- . [4]
- . [2]

USING YOUR CLEANER

- . C
- . [5]
- . A
- . A
- . C F
- . H F
- . C
- . A C
- . [10]
- . [9]
- . [8]
- . [11]
- . [12]
- . [13]
- . [7]
- . [6]
- . [9]
- . [8]
- . [10]
- . [11]
- . [12]
- . [13]

CLEANER MAINTENANCE

Replacing the Dust Bag

- . C
- . [14]
- . [15]
- . F
- . C
- Remember:
- . F
- . [16]

Cleaning the Filter

- . [14]
- . [15]
- . [17]
- . [18]
- . [19]

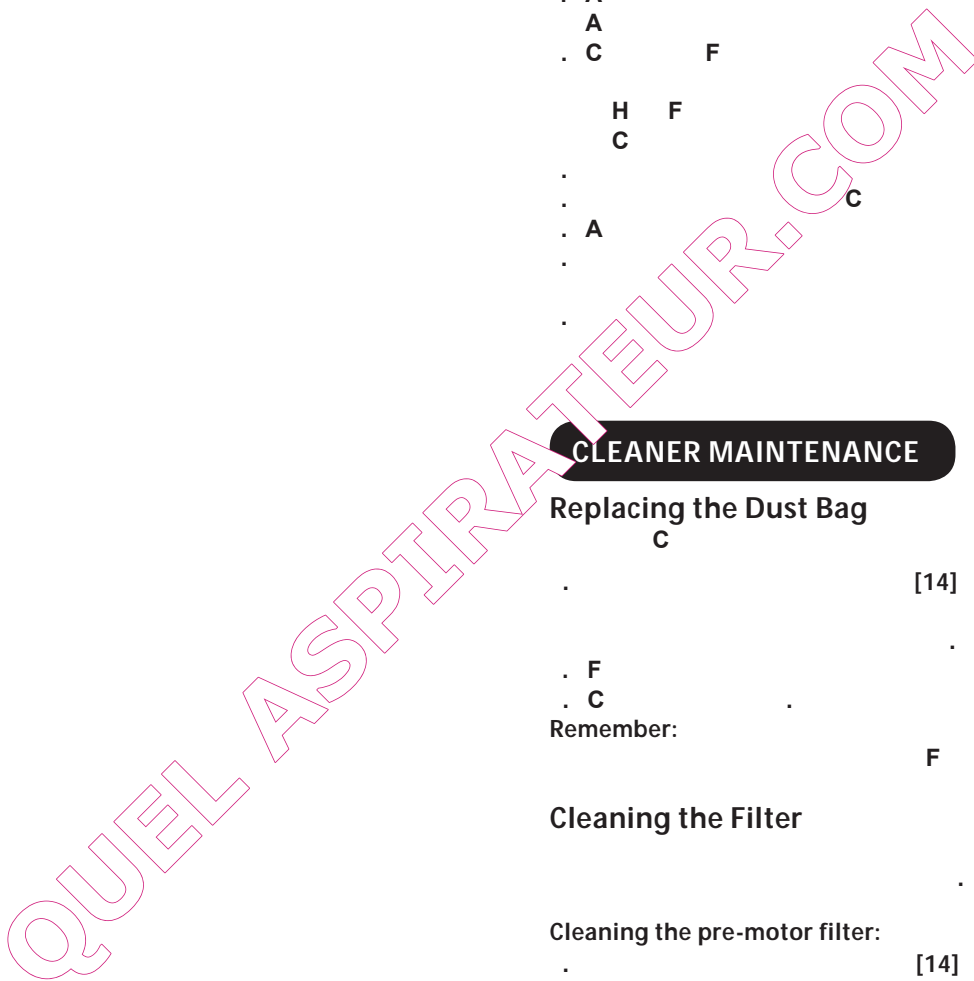

*Certain Models Only ** Certain models only, nozzles may vary according to model

Cleaning the exhaust filter:

[21] [20] [19]

REMEMBER:

H

Cleaning the permanent cloth dust bag* :

Removing a Blockage From The System

C C A C C F

Warning*

ACCESSORIES AND NOZZLES

#1 GP HF CA. A GP A HF A CA

*Certain Models Only ** Certain models only, nozzles may vary according to model

#1 NOTE:

C F [22] A Crevice Tool F [23] Furniture Nozzle F [24] Dusting Brush F [25] Pet Hair Remover Turbo Nozzle

[1V] Allergen Remover Mini Turbo Nozzle*

[1w] Clean Turbo Nozzle* [1X] Pet Nozzle* F [1Y]

IMPORTANT:

USER CHECKLIST

H [] [] C C H

IMPORTANT INFORMATION

Hoover spares and Consumables A H H H F F F H C C F

C F
H F
H F
C

C

Quality
H

Your Guarantee

QUEL ASPIRATEUR.COM

INSTRUCTIONS DE SÉCURITÉ D'UTILISATION

C

C

Service HOVER:

H

C

Environnement

H



Electricité statique: C

H

CE^C
H

CF

C

C

PREMIÈRE UTILISATION



MONTAGE DE L'ASPIRATEUR

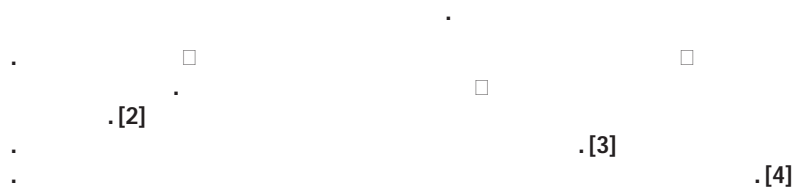

UTILISATION DE L'ASPIRATEUR

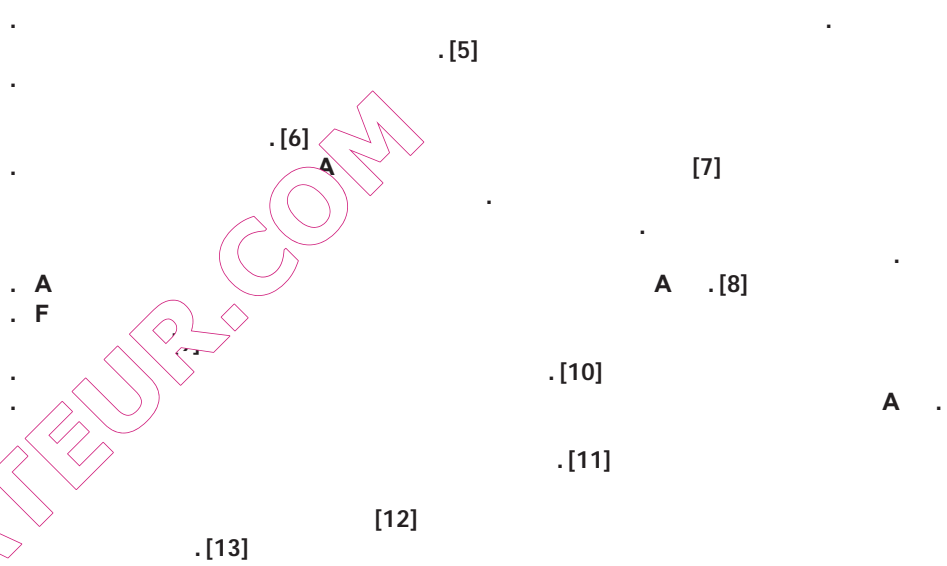

ENTRETIEN DE L'ASPIRATEUR

Remplacement du sac à poussière



Pour nettoyer le filtre



* Sur certains modèles uniquement
 ** Sur certains modèles uniquement, les brosses peuvent varier selon le modèle

. [18]
[19]

Nettoyage du filtre d'évacuation sortie moteur :

[20]
[21]
[19]

Attention:

H

#1 REMARQUE: C

C

Nettoyage du sac à poussière permanent* :

Pour éliminer un blocage dans le système

A.

Mise en garde*

[22]

Suceur
Petit suceur

Brosse meuble

[23]
[24]

[25]

Turbobrosse pour élimination des poils d'animaux domestiques

[1V]

Mini turbobrosse pour élimination des allergènes*

[1W]

Super turbobrosse*

Brosse Caresse*

[1Y]

[1X]

IMPORTANT:

LISTE DES VÉRIFICATIONS À EFFECTUER

ACCESSOIRES ET BROSSES

#1			
C	GP HF CA.		
	GP		
	HF		
	CA		

H			
			<input type="checkbox"/>
			<input type="checkbox"/>
			<input type="checkbox"/>
			<input type="checkbox"/>

*Sur certains modèles uniquement
** Sur certains modèles uniquement, les brosses peuvent varier selon le modèle

INFORMATIONS IMPORTANTES

Pièces détachées et consommables Hoover

H .C
 H .
 H
 F
 F F
 C C C C H H C
 F F
 F F
 H
 C

Qualité

H

Votre garantie

C

QUEL ASPIRATEUR.COM

HINWEISE FÜR DIE SICHERE BENUTZUNG

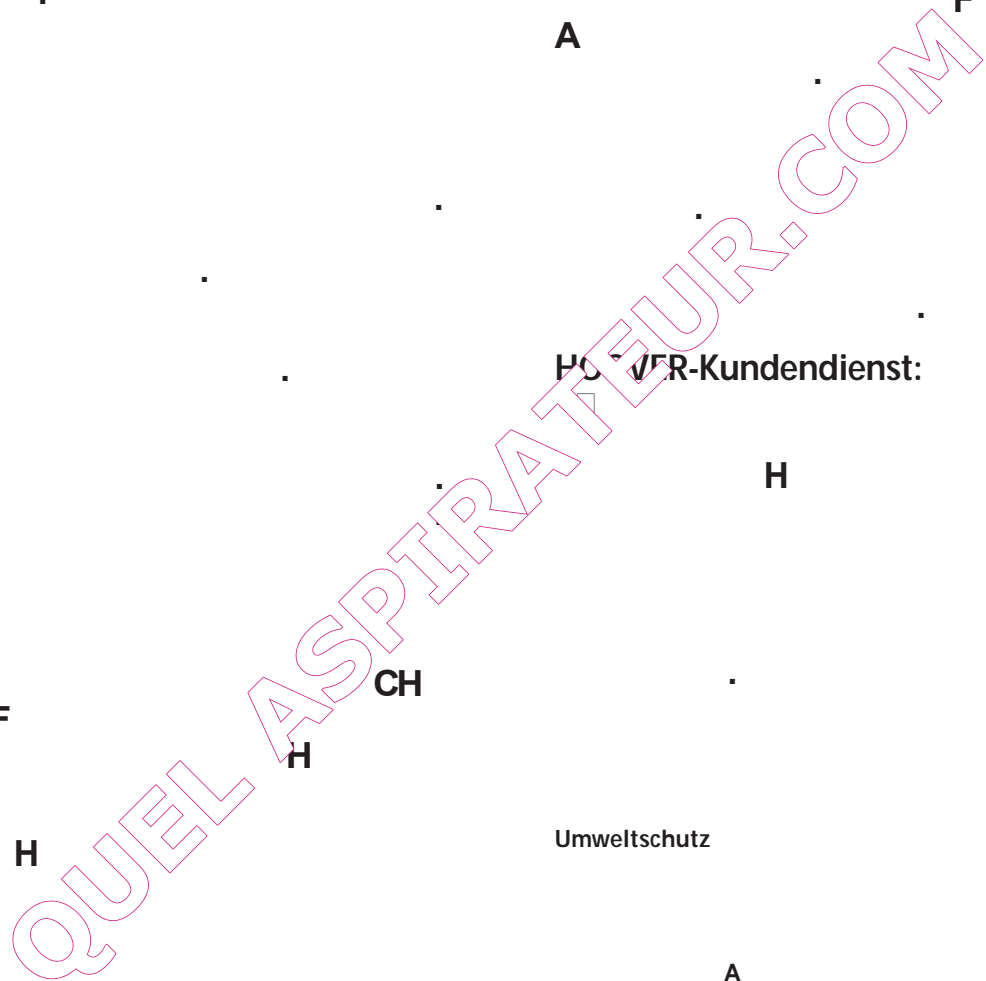

HOVIR-Kundendienst:

Umweltschutz



A

A

A

F

CH

H

F

H

H

Statische Aufladung:

A

F



H



CF

F H .[18]
[19]

CA

Reinigung des Abluftfilters:

F A A .[21]
F [19].

Achtung:

H F H

Reinigung des Permanentstaubbeutels*:

F

#1 HINWEIS:
H

Verstopfung des Saugtraktes beheben

A A F F F

Fugendüse
Polsterdüse
Möbelpinsel F .[24] .[25] .[23]

Achtung*

F A

Miniturbodüse
AllergyRemover-Miniturbodüse* .[1V]
F .[1W]

Turbobodendüse* .[1X]
Hartbodendüse* .[1Y]

WICHTIG:
F H

ZUBEHÖR UND DÜSEN

PRÜFLISTE ZUR FEHLERSUCHE

H
GP HF CA
GP H
HF H

H
F

*Geräteausstattung ist modellabhängig
** Nur bei bestimmten Modellen, Düsen können modellabhängig sein

WICHTIGE INFORMATIONEN

Hoover Original Ersatz- und Verbrauchsteile

H H
H
F
F F H
C C C F F
H H F F
C

Qualität
H

A

Garantierklärung

QUEL ASPIRATEUR.COM

ISTRUZIONI PER UN USO SICURO

QUEL.ASPIRATEUR.COM

Assistenza HOOVER:

Ambiente:



Elettricità statica: A



Pulitura del filtro in uscita:

[20]

[21]

[19]

Nota:

H

#1 NOTA: C

C

Pulitura del sacco raccogli-polvere in stoffa permanente*:

[22]

Rimozione di un'ostruzione dal sistema

Bocchetta per pressare
Bocchetta per tutti gli usi
Spazzola a pennello

[24]

[23]

[25]

Turbo-spazzola per rimuovere i peli di animali domestici

[1V]

Mini turbospazzola per rimuovere gli allergeni*

[1W]

Spazzola Grand Turbo*

[1X]

Spazzola Parquet *

[1Y]

Avvertenza*

IMPORTANTE:

ACCESSORI E SPAZZOLE

CHECKLIST UTENTE

#1

H

GP HF CA.

C

GP

HF

CA

*Solo su alcuni modelli

** Solo su alcuni modelli, le spazzole possono variare secondo il modello

INSTRUCTIES VOOR VEILIG GEBRUIK

QUEL ASPIRATEUR.COM

HOOFD dienstverlening:

H

H

H

Het milieu
H



H

Statische elektriciteit:



H

CF

C

C

[19]

Het uitlaatfilter reinigen:

[21]

[19]

[20]

Niet vergeten:

H

Permanente stofzak reinigen * :

Verstoppingen uit het systeem verwijderen

- . C
- . A
- . A
- . C

H

Waarschuwing*

.A

.A

H

A

A

#1 OPM.

C

H

[22]

A

Kieremandsak
Met of zonder stuk
stofzuiger

[24]

[23]

[25]

Turbozuigmond voor dierenharen

[1V]

Miniturbozuigmond voor allergene stoffen*

[1W]

Grand Turbozuigmond*

[1X]

Zuigmond voor parket*

[1Y]

BELANGRIJK:

. H

CHECKLIST GEBRUIKER

H

C

- .
- .
- .
- .
- .



GP HF CA.

ACCESSOIRES EN ZUIGMONDEN

- GP
- HF
- CA

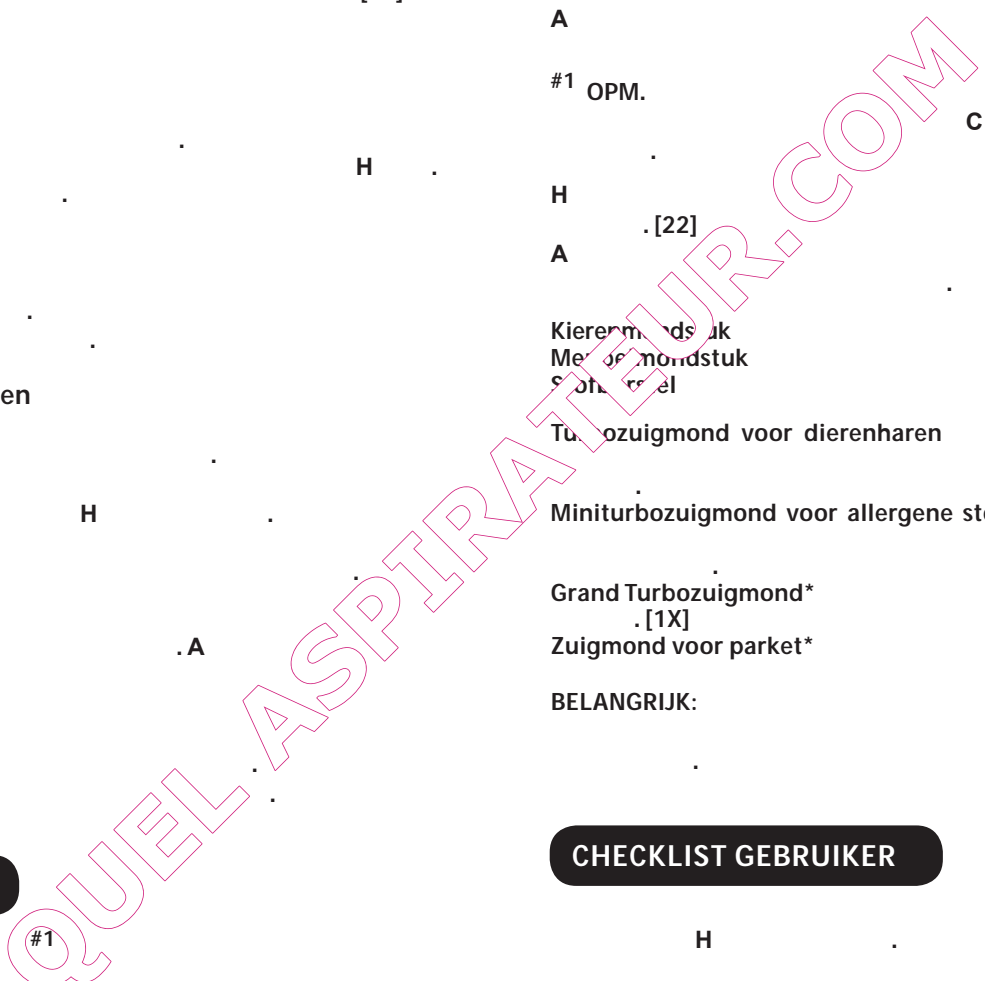

*Alleen bepaalde modellen

**Solo su alcuni modelli, le spazzole possono variare secondo il modello

BELANGRIJKE INFORMATIE

Originele reserveonderdelen en toebehoren van Hoover

H .A .
H
F
F F H
C C F F
C C F F
H F
H F
C
C

Kwaliteit H

Uw garantie

QUEL ASPIRATEUR.COM

INSTRUÇÕES PARA UMA UTILIZAÇÃO SEGURA

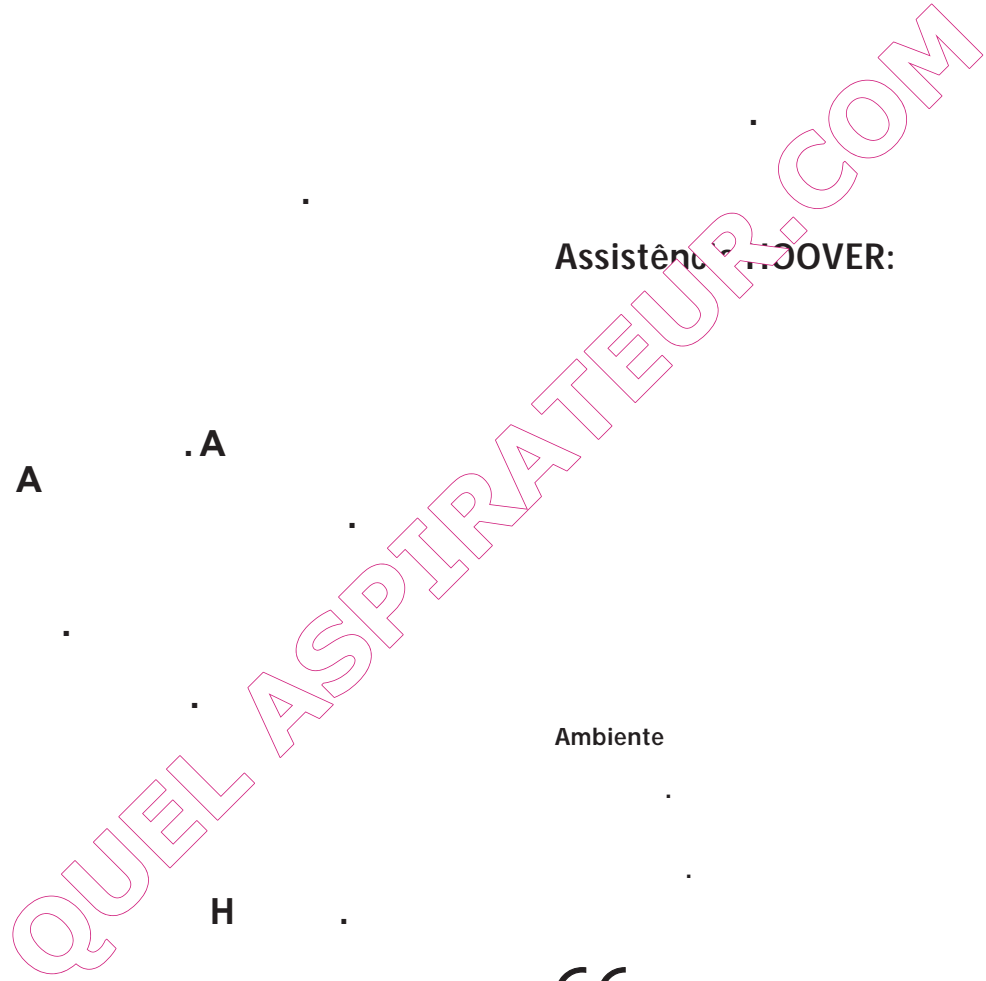

Assistência COVER:

H

H

Ambiente



Electricidade estática: A

CE c c
H

CF

Limpeza o filtro de exaustão:

[20]

[21]

[19]

Nota:

H

Limpeza da bolsa de pano para o pó permanente*:

Remoção de uma obstrução do sistema

C

A

C

Atenção*

C

#1 NOTA: A

A

[22]

Acessório para...

[23]

Escova para...

[24]

Escova para...

[25]

Escova turbo para remover pêlos de animais

[1V]

Mini escova turbo para remoção de alérgenos*

[1W]

Escova turbo grande*

[1X]

Escova para parquet*

[1Y]

IMPORTANTE:

ACESSÓRIOS E ESCOVAS

A

HF CA.

GP

HF

CA

A

LISTA DE VERIFICAÇÃO DO UTILIZADOR

H

- •
•
•
•

C

C

C

□

□
A

A

*Apenas Alguns modelos

**Apenas alguns modelos, as escovas podem variar dependendo do modelo

INFORMAÇÕES IMPORTANTES

Peças sobressalentes e consumíveis Hoover

C C C H H C
F F F F
H H
H H
C

H H H

Qualidade
A

C H

Garantia
A

A

QUEL ASPIRATEUR.COM

INSTRUCCIONES PARA UN USO SEGURO

A

.A

Servicio técnico HOOVER:

H

El Medio Ambiente:



Electricidad estática: A

QUEL ASPIRATEUR.COM

A



C

C

CF

[19]

Limpieza del filtro de salida:

[20]

[21]

[19]

Recuerde:

H

#1 NOTA:

C

Limpieza de la bolsa de polvo permanente de tela* :

[22]

Eliminación de obstrucciones en el sistema

Accesorio para tapicerías

[23]

Cepillo para muebles

[24]

Cepillo para quitar el polvo

[25]

Tobera Turbo para el pelo de los animales

[1V]

Tobera Mini Turbo elimina alérgenos*

[1W]

Maxi Tobera Turbo*

[1X]

Tobera Parquet *

[1Y]

IMPORTANTE:

Advertencia*

ACCESORIOS Y CEPILLOS

LISTA DE COMPROBACIONES QUE DEBE REALIZAR EL USUARIO

- GP
- HF
- CA

GP, HF CA.

- H
- .
- .
- .
- .

C

A

A

H

*Sólo algunos modelos

**Sólo para algunos modelos, las toberas pueden variar en base al modelo

INSTRUKTIONER FOR SIKKER ANVENDELSE:

QUEL ASPIRATEUR.COM

HØRBYER-SERVICE: F

H

H

H .F

H

Miljøet

H

.F



Statisk elektricitet:



C

C

H

CF

KEND DIN STØVSUGER

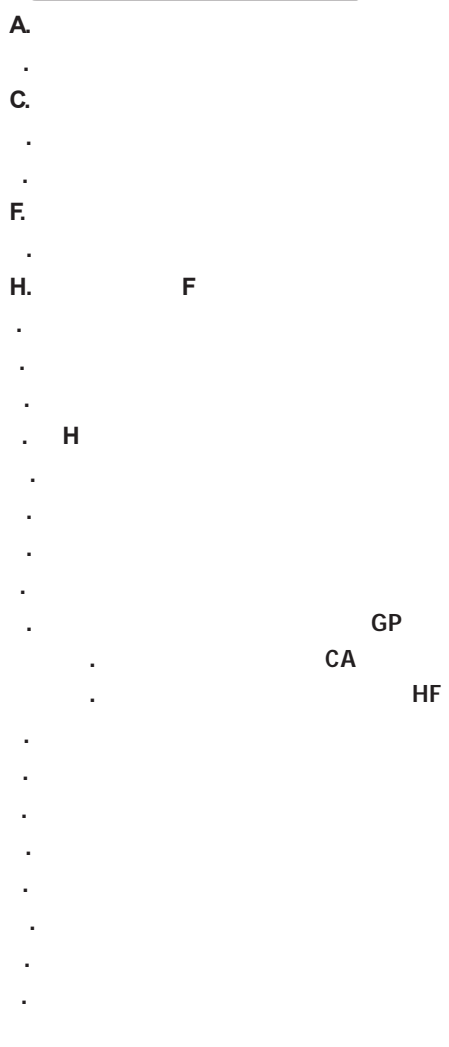

BRUG AF STØVSUGEREN

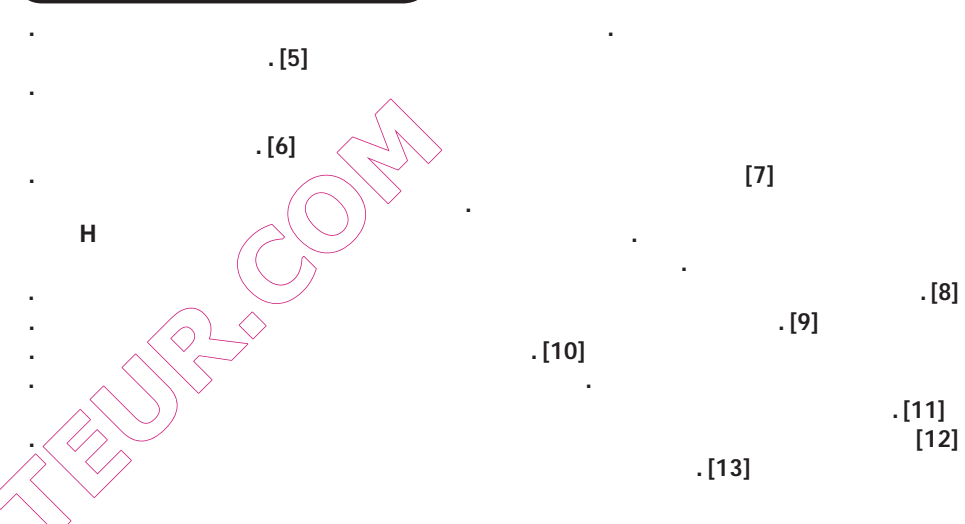

VEDLIGEHOLDELSE AF STØVSUGEREN

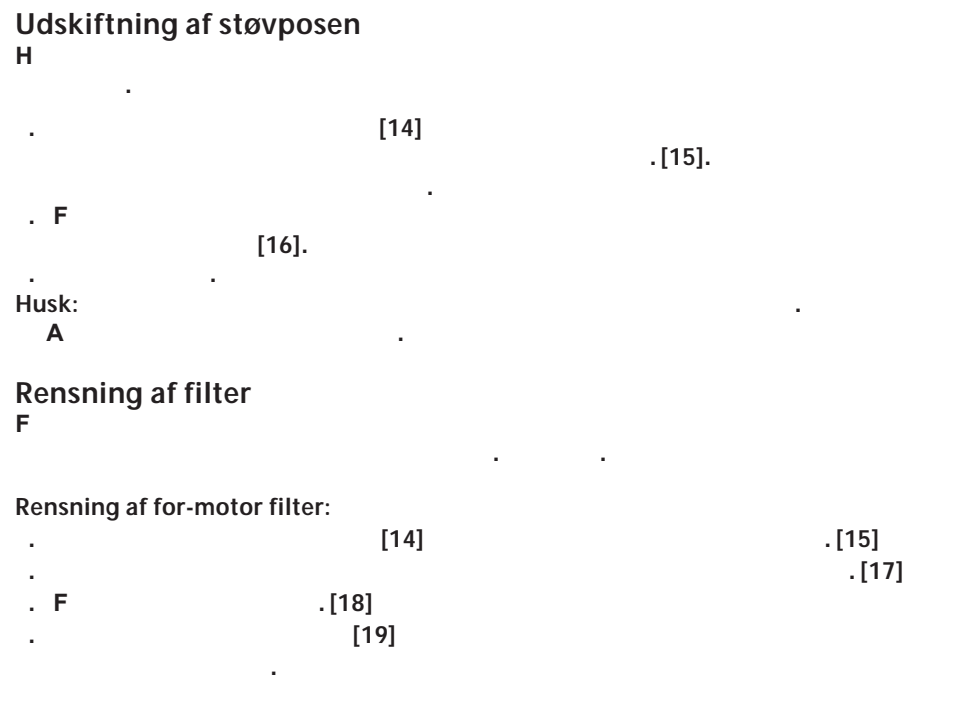

MONTERING AF STØVSUGEREN

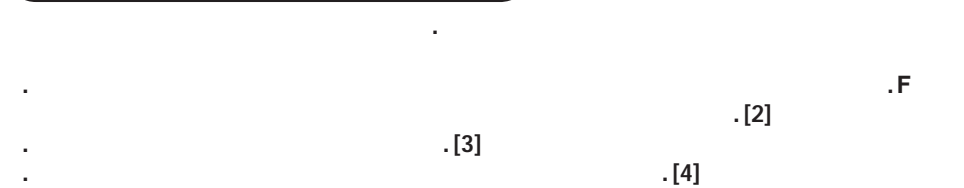

*Kun til visse modeller
 ** Kun på visse modeller kan mundstykkerne variere alt efter modeltype

INSTRUKSJONER FOR SIKKER BRUK

A

A

H

H

H

Statisk elektrisitet:

QUEL ASPIRATEUR.COM

A

A

HOOVER-service

A

Miljøet

CE c

H

H

A

C

CF



BLI KJENT MED STØVSUGEREN DIN

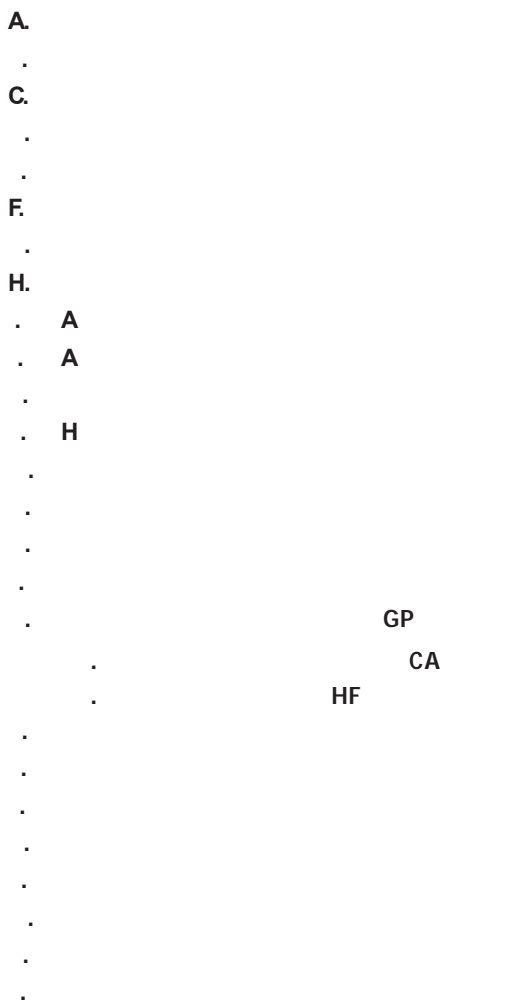

BRUK AV STØVSUGEREN

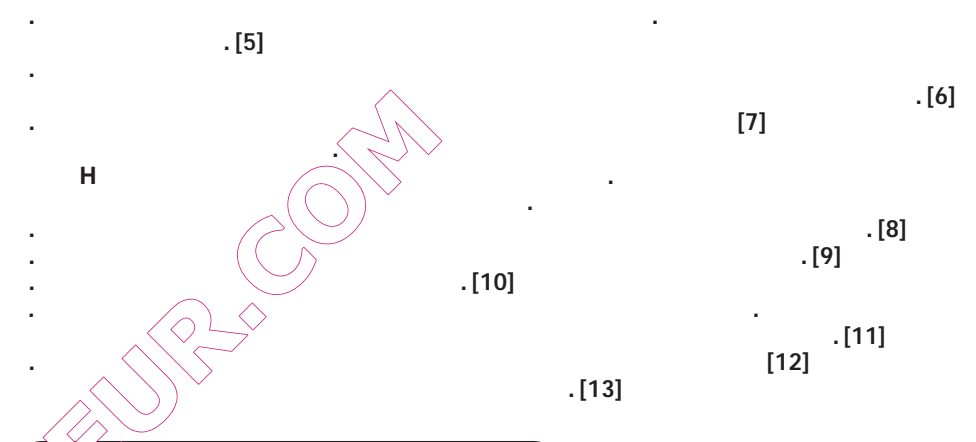

VELLİKEHOLD AV STØVSUGEREN

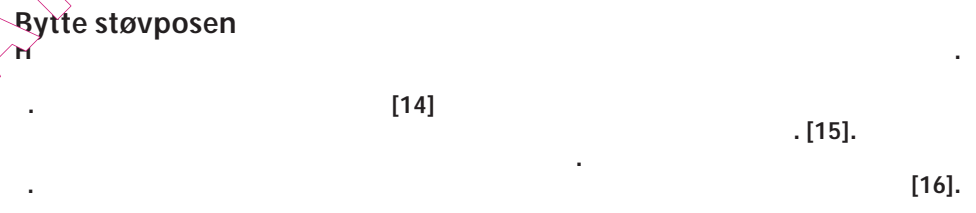

Husk: F

Rense filteret
F

Rengjøring av pre-motor-filteret:
 . F [14] [15]
 . F [18] [17]
 . [19]

Rengjøring av avgassfilteret:
 . F [20] [19] [21]

Husk: [19] H

MONTERE STØVSUGEREN

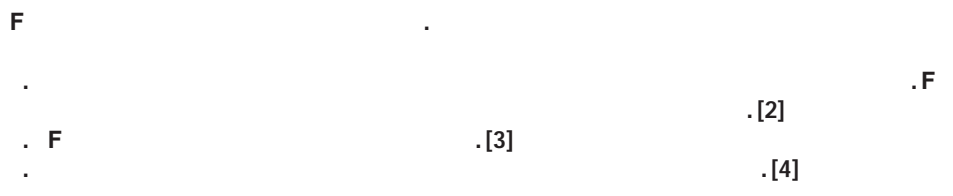

*Bare enkelte modeller
 **Kun for enkelte mdeller. Munnstykkene kan variere fra modell til modell

Rengjøre den permanente støvposen* :

F .[1W]

Fjerne en blokkering fra systemet

H
.H
.H
A H

ADVARSEL:*

F .H
.A

TILBEHØR OG MUNNSTYKKER

F #1

GP, HF CA.
GP
HF
CA

H

H

#1 MERK:

. [22]

A

att munnstykke, . [23]

møbelmunnstykke, . [24]

støvbørste F . [25]

Turbomunnstykke for dyrehår

. [1V]

Miniturbomunnstykke for allergen*

*Bare enkelte modeller

**Munnstykkene kan variere fra modell til modell

Stort turbomunnstykke*

Munnstykke for parkett*

. [1X]
. [1Y]

VIKTIG:

SJEKKLISTE FOR SKIFTER

H

. F

.

.

.

.

VIKTIGE OPPLYSNINGER

Originaldeler fra Hoover

H H H

H H

F F

C C F H

C C F F

H H F

H H F

C

C

Kvalitet

H

Din garanti

INSTRUKTIONER FÖR SÄKER ANVÄNDNING

QUEL ASPIRATEUR.COM

F

HOOVER service: F

H

A

Miljön



CE

H

CF

H

A

Statisk elektricitet:

A

BEKANTA DIG MED DAMMSUGAREN



ANVÄNDA DAMMSUGAREN

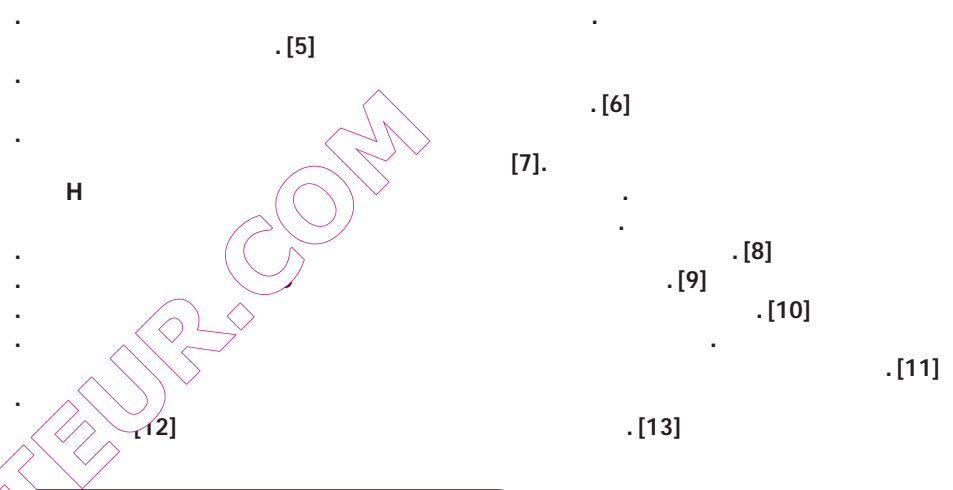

UNDERHÅLL AV DAMMSUGAREN

Utbyte av dammpåse



Kom ihåg:

Rengöring av filtret

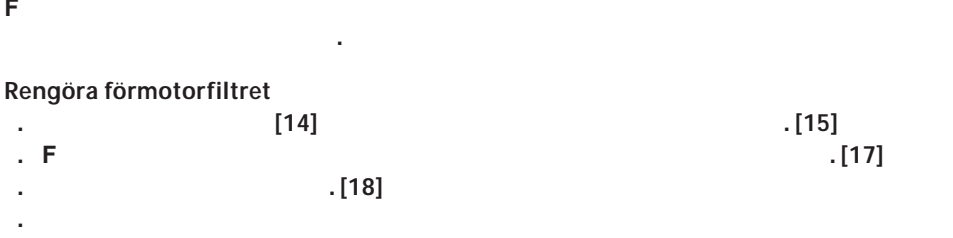

Rengöra utblåsningsfiltret



SÄTTA IHOP DAMMSUGAREN

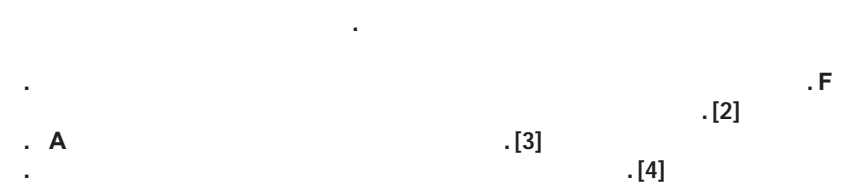

*Endast vissa modeller
**Endast vissa modeller, munstycken kan variera beroende på modell

Kom ihåg: A

H

A

#1 OBS!

Rengöring av den fasta damppåsen :
F

F

[22]

A

Ta bort ett stopp i systemet

Verktyg för springor F

[23]

Möbelmunstycke F

[24]

Dammborste F

[25]

Turbomunstycke för borttagning av djurhår A

A

A

Allergenavlägsnande miniturbomunstycke* A

[1W]

Storturbomunstycke* A

[1X]

Perfekt munstycke* F

[1Y]

Varning*

VARNING: A

H

A

CHECKLISTA FÖR ANVÄNDAREN

H

H

-
-
-
-
-



TILLBEHÖR OCH MUNSTYCKEN

F

#1

GP HF CA

- GP
- HF
- CA

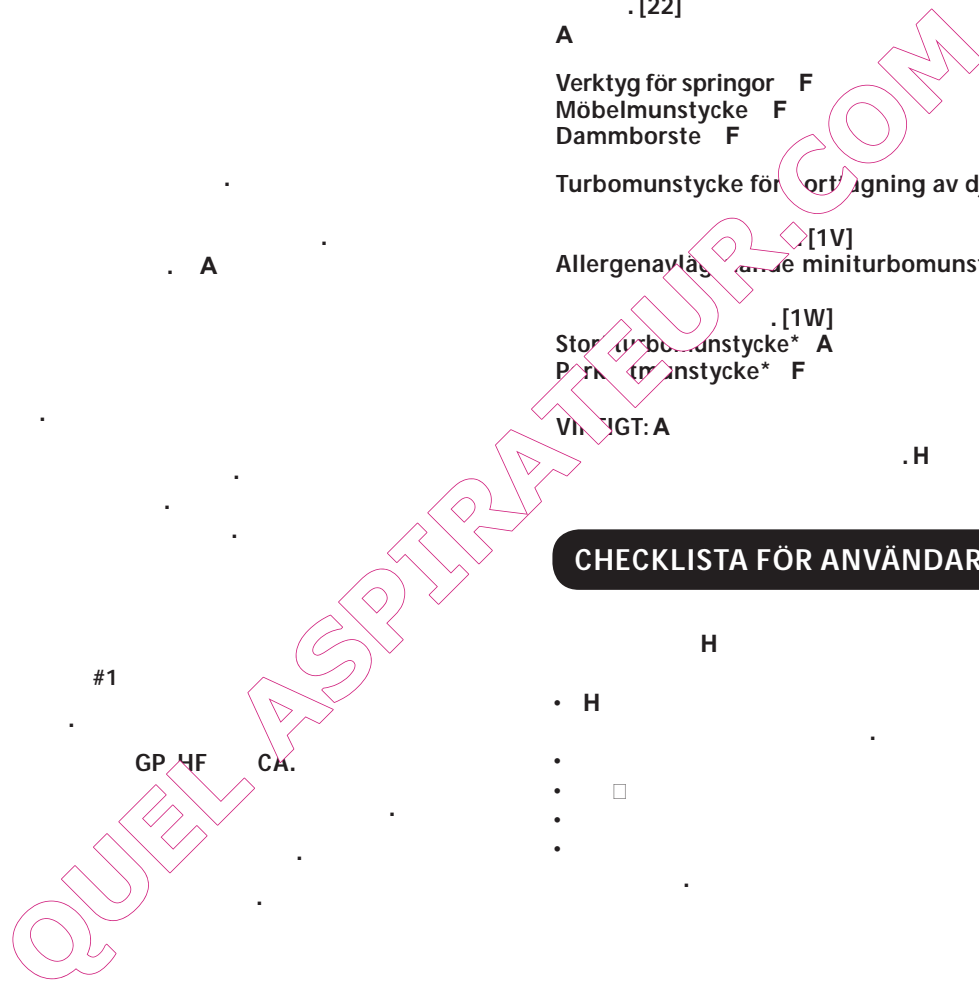

*Endast vissa modeller

**Endast vissa modeller, munstycken kan variera beroende på modell

OHJEET TURVALLISTA KÄYTTÖÄ VARTEN

QUEL ASPIRATEUR.COM

HOOVER-huolto

H

Ympäristö

H

CE

H

CF



Staattinsähkö:

IMURIN OSAT

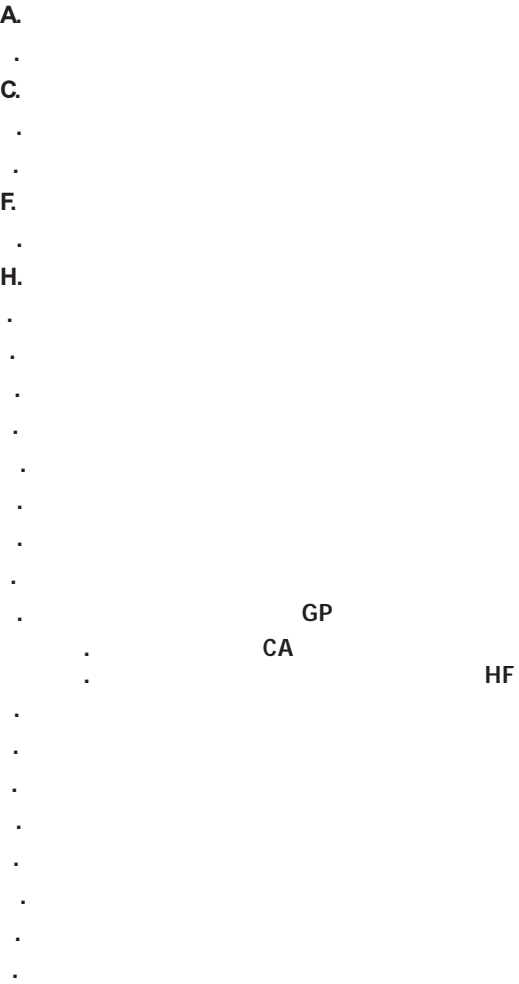

IMURIN KOKOAMINEN

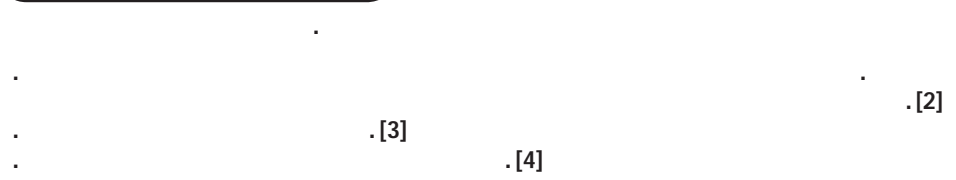

IMURIN KÄYTTÖ

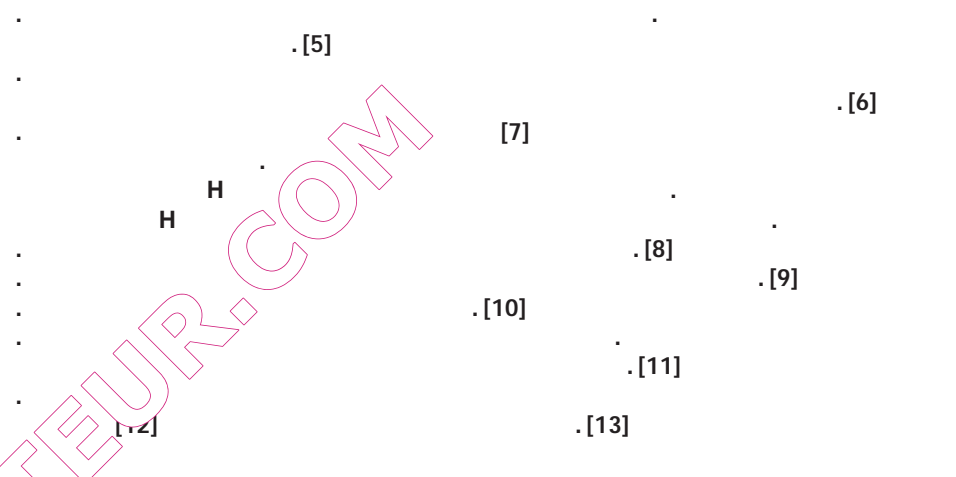

IMURIN KUNNOSSAPITO

Pölypussin vaihto



Muista:

Suodattimen puhdistaminen

Moottorin esisuodattimen puhdistaminen



*Vain joissakin malleissa
**Vain joissakin malleissa, suulakkeet saattavat vaihdella mallista riippuen

Poistosuodattimen puhdistaminen

[20]

[21]

[19]

Muista:

H

#1 HUOMAA:

Kiinteän pölypussin puhdistaminen*:

[22]

Tukoksen poistaminen imurista

Rakosuutin

[23]

Tekstiilisuu

[24]

Pölysuu

[25]

Eläinlääketeivosuutin

[1V]

Pieni allergiateivosuutin*

[1W]

Tehosuutin*

[1X]

Parkettisuutin**

[1Y]

Varoitus*

TÄRKEÄÄ:

VIANMÄÄRITYSLISTA

LISÄVARUSTEET JA SUUTTIMIT

#1

H

GP HF CA.

GP

HF

CA

*Vain joissakin malleissa

**Vain joissakin malleissa, suulakkeet saattavat vaihdella mallista riippuen



H

QUEL ASPIRATEUR.COM

Hoover:

H

H

H

μ :



CE

C

C



A.

C.

F.

H.

.

.

.

.

.

.

.

.

.

.

.

.

.

.

.

*

**

(CA) (GP) (HF)



[5]

[6]

[7]

[8]

[9]

[10]

[11]

[12]

[13]

[14]

[15]

[16]

μ :

μ

μ

μ :

[14]

[2]

[3]

[4]

QUEL ASPIRATEUR.COM

[15]

HF

CA

[17]

[18]

[19]

μ

[20]

[21]

[19]

μ :

H

#1

μ μ μ μ *

[22]

μ

μ

μ

[23]

[24]

[25]

μ

A

μ Turbo

[1V]

MiniTurbo *

[1W]

Grand Turbo*

[1X]

Parkettisuutin**

[1Y]

#1

GP HF CA.

GP

* μ μ (μ)
** μ μ

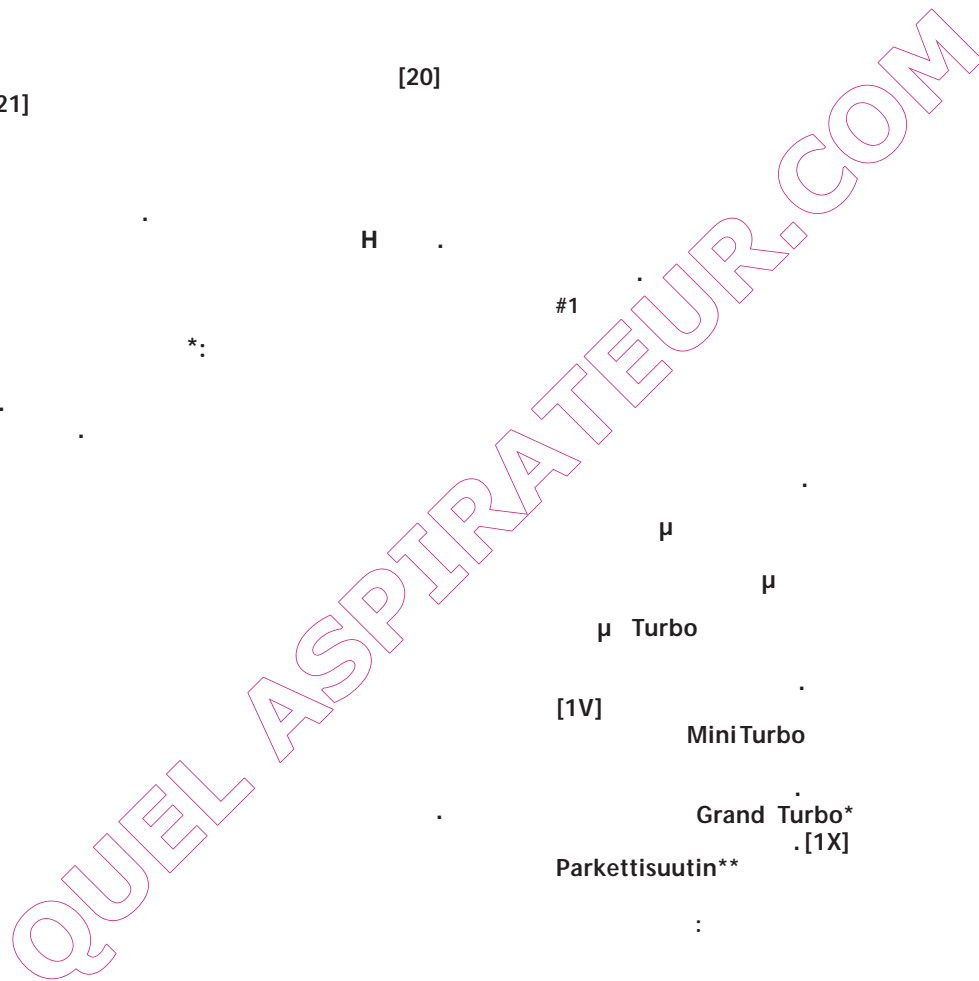



H

•
•
•
•
•



μ Hoover

H

H

H

H

F
F
F
F

H

C
C
C
H
H
C

F
F

C

H

QUEL ASPIRATEUR.COM



QUEL ASPIRATEUR.COM

HOOVER:

H

H

H

CE

c

C



. [18]

[19]

. [17]

HF
CA

. [21]

[19]

[20]

H

#1

*,

. [22]

. [23]

. [24]

. [25]

A.

. [1V]

. [1W]

Grand*

. [1X]

. [1Y]

!

#1

GP HF CA.

GP

QUEL ASPIRATEUR.COM



H

- .
- .
- .
- .
- .



Hoover

H

H

H

H

F

H

F

F

F

F

F

C

C

C

H

H

C

C

H

QUEL ASPIRATEUR.COM

INSTRUKCJE BEZPIECZNEGO UŻYTKOWANIA

QUEL ASPIRATEUR.COM

Service my HOOVER: A

H

H

Ochrona środowiska



H

Ładunki elektrostatyczne:



ELEMENTY ODKURZACZA

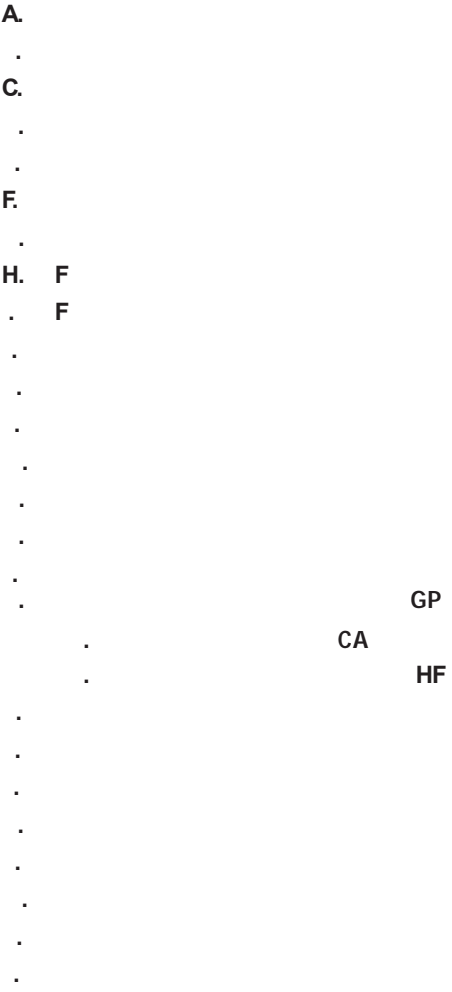

MONTA ODKURZACZA

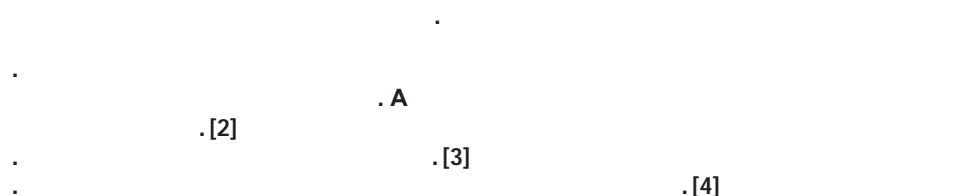

KORZYSTANIE Z ODKURZACZA

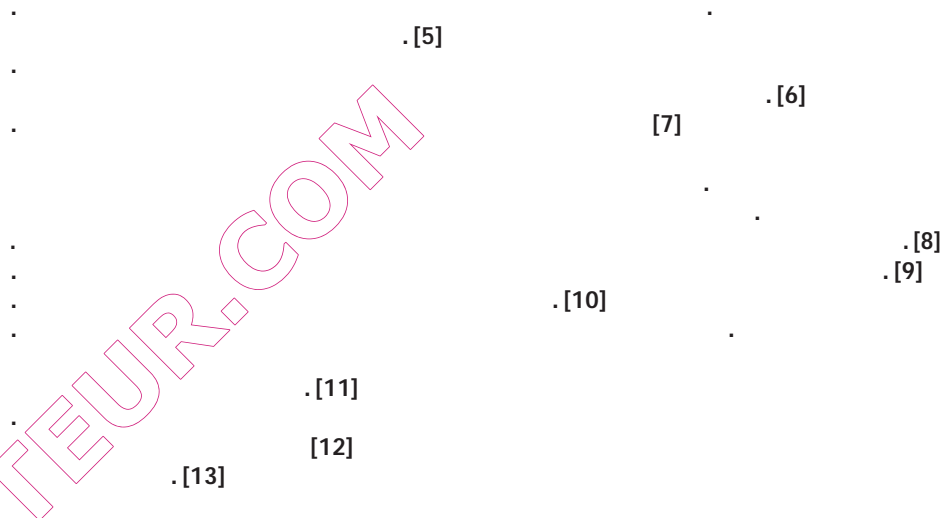

KONSERWACJA ODKURZACZA

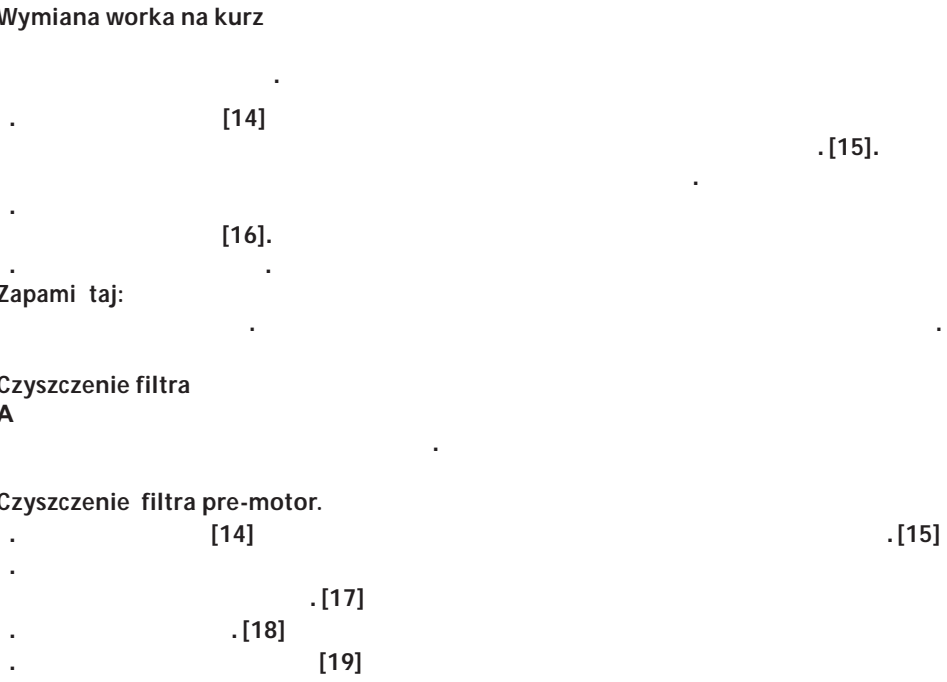

*Tylko w niektórych modelach
 **Jedynie w niektórych modelach. Kołowki mogą się różnić w zależności od modelu

Czyszczenie filtra wywiewu:

A [20] .[21]
[19]

Zapamiętaj:

H #1 UWAGA:

Czyszczenie stałego worka na kurz*:

A [22]

Usuwanie niedrogości z układu

Ssawka szczotkowa [23]

Szczotka do mebli [24]

Szczotka do parkietów [25]

Turbo szczotka do usuwania sierści zwierząt

Turboszczotka mini do usuwania alergenów*

A C

Ostrzeżenie*

Szczotka Turbo* [1W]
Szczotka do parkietów* [1X]
[1Y]

WAŻNE:

AKCESORIA I SSAWKI

LISTA KONTROLNA UŻYTKOWNIKA

A
#1
HF CA.
GP
HF
CA

- C
- C
- C
- C
- C

H

*Tylko w niektórych modelach

**Jedynie w niektórych modelach. Kółka mogą się różnić w zależności od modelu

WAŻNE INFORMACJE

Części zapasowe i materiały eksploatacyjne firmy Hoover

C
C
C
H
H
C

F
F
F
F
F

H

H

H

H

H

C

Jakość H

Gwarancja

QUEL ASPIRATEUR.COM

NÁVOD K BEZPEČNÉMU POUŽITÍ

QUEL ASPIRATEUR.COM

Servisní číslo

H

H

Životní prostředí



CE

H

CF

Statická elektřina

SEZNÁMENÍ S VYSAVA EM

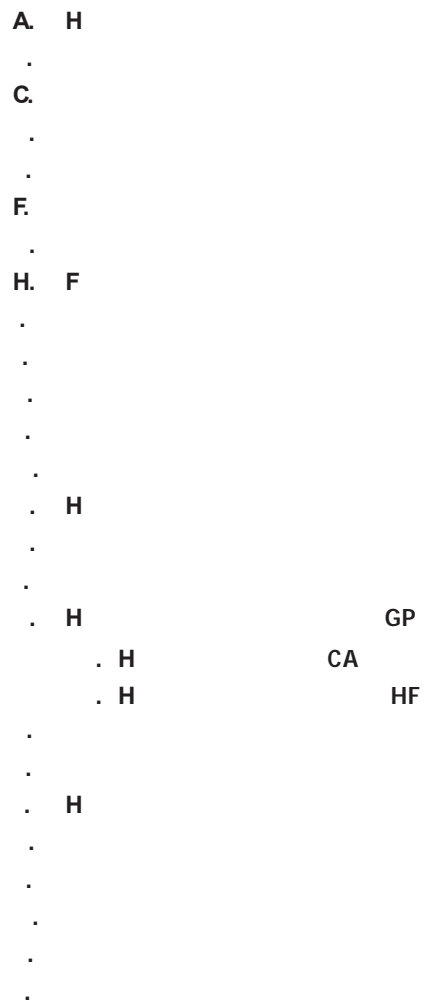

JAK POUŽÍVAT VYSAVA

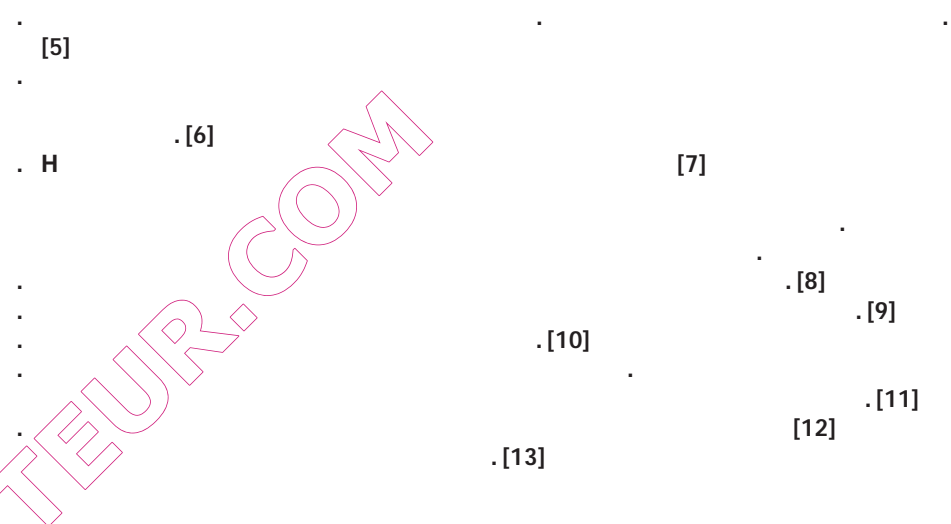

ÚDRŽBA VYSAVA E

Vým na sá ku na prach

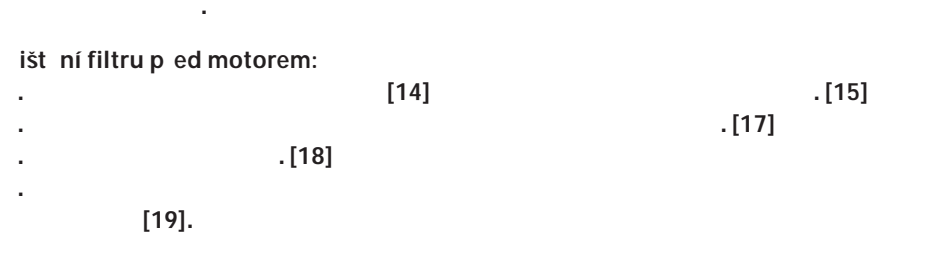
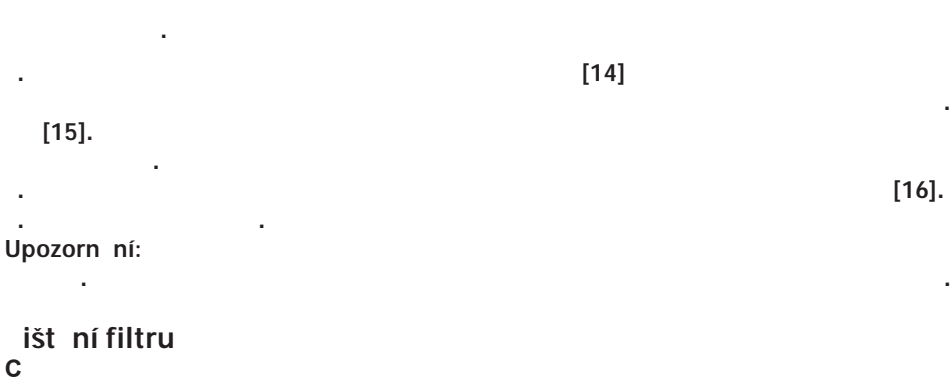

SESTAVENÍ VYSAVA E

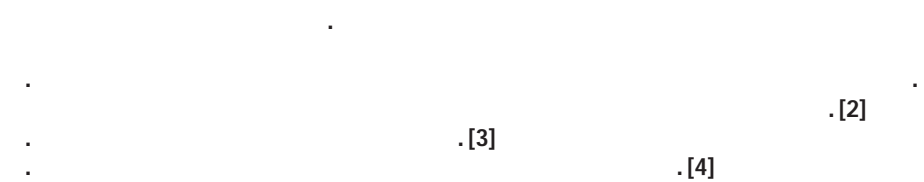

*Pouze u n kterých model
 **Pouze n které modely, hubice se m že lišit dle modelu

ištění výstupního filtru:

[20]

[21]

[19]

Upozornění:

#1 POZNÁMKA:

H

ištění trvalého tkaninového sáčku na prach*:

[22]

Odstranění překážky ze sacího systému

Štěrbinová hubice*
Hubice na čalounářský nábytek
Prachová kartáček

[23]

[24]

[25]

Turbohubice na ištění chlupců zvířat

A

[1V]

Miniturbohubice na ištění alergenů*

[1W]

Velká turbohubice* H
Parketová hubice*

[1X]

[1Y]

Varování*

DŮLEŽITÉ UPOZORNĚNÍ:

KONTROLNÍ SEZNAM UŽIVATELE

TRYSKY A PŘÍSLUŠENSTVÍ

C

#1

H

H CA.

F

GP

HF

CA

*Pouze u některých modelů

**Pouze u některých modelů, hubice se mohou lišit dle modelu

D LEŽITÉ INFORMACE

Náhradní díly a spotřební materiály Hoover

H H H
H H
H
F
F F H
C C F F
C C F F
H H F
H H F
C

Kvalita

H

Záruka

QUEL ASPIRATEUR.COM

NAVODILA ZA VARNO UPORABO

QUEL ASPIRATEUR.COM

Servi. H DOVER:

H

H

Okolje



CE

H

CF

Stati na elektrika:

iš enje izpušnega filtra:

[20]

F [21] [19]

Ne pozabite:

H

iš enje trajne vre ke za prah iz blaga*:

#1 OPOMBA:

Nastavek za sesanje re. [22] [23]
Nastavek za p. štv. [24]
Krta a za pra. [25]

Odpravljanje zamašitve

Turbo š. ha z. dlake doma ih živali [1V]
ini. o krta a za alergene delce*

A.

elika Turbo krta a* [1W]
Nastavek za iš enje parketa* [1Y] [1X]

OPOZORILO*

POMEMBNO:

KONTROLNI SEZNAM ZA UPORABNIKA

DODATNI PRIKLJU KI IN NASTAVKI

GP, HF

GP
HF
CA

*Le pri dolo enih modelih
** Samo dolo eni modeli, nastavki se lahko spreminjajo glede na model.

GÜVENLİ KULLANIM YÖNERGELERİ

A

A

A

A

HOOVER servisi: C

H

A

H

Çevre

H

Statik elektrik:

CE
H

C

C

A

CF

A



SÜPÜRGENİZİ YAKINDAN TANIYIN



SÜPÜRGENİZİ KURULMASI

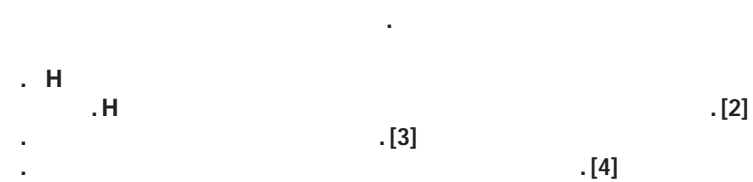

SÜPÜRGENİZİ KULLANIRKEN

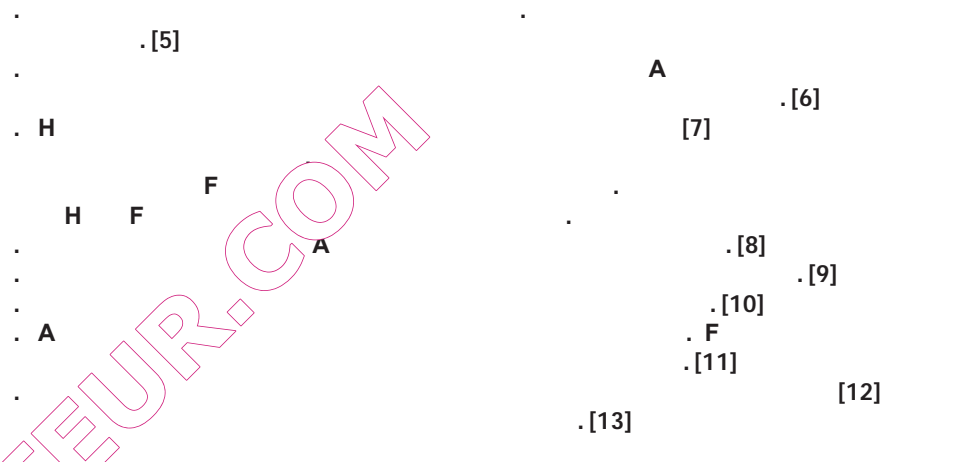

SÜPÜRGENİZİN BAKIMI

Toz Torbasının De iştirilmesi

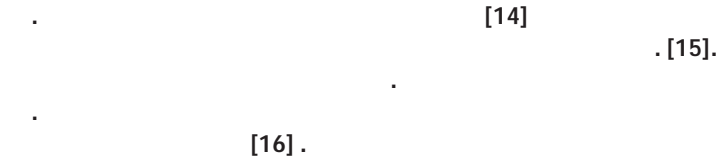

Unutmayın:

Filtreyi Temizleme

Ön motor filtresinin temizlenmesi:

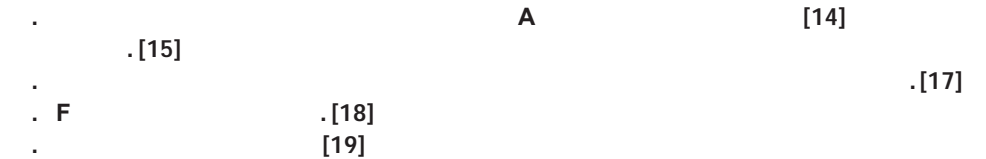

*Sadece bazı modeller için

**Yalnızca belirli modeller, bazı modeller modele göre de iştiriklik gösterebilir

Çıktı filtresinin temizlenmesi:

[20]

A

A

[21]

F

Unutmayın:

H

F

Daimi kuma lı toz torbasının* temizlenmesi :

F

Sistemdeki Tıkanıklı ın Giderilmesi

A F

F

Uyarı:*

#1 NOT: H

A

A

A

[22]

Destek Parçası

[23]

Mobilya Baskını

[24]

Toz Alın Filtresi

[25]

Hayvan Tüyü Giderici Turbo Baskın

[1V]

Alerjen Giderici Mini Turbo Baskın*

[1W]

Büyük Turbo Baskın*

[1X]

Baskın Bırakma Yuvası*

[1Y]

ÖNEMLİ :

F

KULLANICI KONTROL LİSTESİ

H

-
-
- F
- H
-

AKSESUARLAR VE BASKINLAR

#1

GP HF CA

GP

HF

CA

*Sadece bazı modeller için

**Yalnızca belirli modeller, baskınlar modele göre de i iklik gösterebilir

ÖNEMLİ BILGI

Hoover yedek parça ve sarf malzemeleri

H H
H
H
F
F
C C C H
H F
H F
C
C
H
H
C

Kalite

H

Garanti

H

QUEL ASPIRATEUR.COM

*Sadece bazı modeller için

**Ba lıklar modele göre de i iklik gösterebilir

BIZTONSÁGOS HASZNÁLAT

QUEL ASPIRATEUR.COM

A

A

A

H

HOOVER víz: A

H

A

A

A

H

A

H

Környezetvédelem:

A

A

A

A



A

C

H

Statikus elektromosság:

A



H

C

C

CF

A

A kipufogó szűrő tisztítása:

A [20] [21] [19]

Ne feledje:

A H

Az állandó ruha zsák tisztítása* :

A

Dugulás eltávolítása a rendszerből

H

A H A A

Figyelmeztetés* A

A

A

KIEGÉSZÍTŐK ÉS FEJEK

A

#1

GP HF CA

AGP

AHF

ACA

A

*Csak bizonyos modellek esetén

**Csak bizonyos típusok esetén, a szívófejek típusonként eltérőek lehetnek

F

H

H

#1 MEGJEGYZÉS:

A

[22]

A

Réstisztító szűrő

Bútortisztító

Porkefe

Állóeltávolító, turbófej A

Allergén eltávolító, mini, turbófej* A [1V]

Grand Turbo fej* H [1W]

Padlóápoló fej* H

FONTOS: A

A

FELHASZNÁLÓI ELLENŐRZÉSI LISTA

A

H

A

A

A

A

A

A

A

A

A

